



# SUCTION CABINET

## ECONO SERIE



**Models : 2636 - 2844 - 3636 - 3648**  
**With DB 13 Dust bag & DC 50 / DC 100 Dust collector**

- Warranty
- Safety
- Operation
- Service Parts
- Accessory Information
- Registration Form



# INSTRUCTION MANUAL & PARTS

## TABLE DES MATIÈRES

	<b>Page</b>
GARANTIE LIMITÉE CANABLAST .....	3
SPÉCIFICATIONS DU CABINET .....	4
AVIS AUX ACHETEURS ET UTILISATEURS DE NOS PRODUITS ET DE CE DOCUMENT D'INFORMATIONS .....	5
SÉCURITÉ AND MISE EN GARDE .....	5
ÉTIQUETTES DANGER ET AVERTISSEMENT .....	6
UTILISATION ET MAINTENANCE DE L'APPAREIL .....	7
RÈGLES DE SÉCURITÉ GÉNÉRALES .....	7
INTRODUCTION .....	8
INSTALLATION .....	8
CHARGEMENT DES MÉDIAS ABRASIFS.....	9
MISE EN MARCHÉ .....	9
ARRÊT DE LA MACHINE .....	9
UTILISATION DE VOTRE CABINET À SUCCION.....	10
SCHÉMA DE L'UNITÉ - VUE CÔTÉ DROIT .....	11
SCHÉMA DE L'UNITÉ - VUE DE FACE .....	12
SCHÉMA DE L'UNITÉ - VUE DE L'INTÉRIEUR.....	13
SCHÉMA DE L'UNITÉ - VUE ARRIÈRE .....	14
SCHÉMA DE L'UNITÉ -- LISTE DES PIÈCES .....	15
AJUSTEMENT DU RÉGULATEUR D'ABRASIF AR 3/4 (608010).....	16
PISTOLET G15 POUR CABINET SUCCION .....	16
PISTOLET G15 POUR CABINET SUCCION - LISTE DES PIÈCES .....	17
PISTOLET G15 POUR CABINET SUCCION - LISTE DES PIÈCES (PRÉ-ASSEMBLÉ).....	18
INFORMATION DE GARANTIES / ASSISTANCE TECHNIQUE.....	19
ENREGISTREMENT DE LA GARANTIE CANABLAST .....	20

## **CANABLAST LIMITED WARRANTY**

**CANABLAST warrants all equipment led in this manual which is manufactured by CANABLAST and bearing its name, to be free from defects in material and workmanship on the date of sale by an authorized CANABLAST distributor to the original purchaser for use. Notwithstanding any special, extended or limited warranty published by CANABLAST will, for a period of TWELVE (12) months from the date of sale, repair or replace any part of the equipment determined by CANABLAST to be defective. This warranty applies only when the equipment is installed, operated and maintained in accordance with CANABLAST's written recommendations.**

**This warranty does not cover, and CANABLAST shall not be liable for general wear and tear, or any malfunction, damage or wear caused by faulty installation, misapplication, abrasion, corrosion, inadequate or improper maintenance, negligence, accident, tampering, or substitution of non- CANABLAST component parts. Nor shall CANABLAST be liable for malfunction, damage or wear caused by the incompatibility with CANABLAST equipment with structures, accessories, equipment or materials not supplied by CANABLAST, or the improper design, manufacture, installation, operation or maintenance of structures, accessories, equipment or materials not supplied by CANABLAST.**

**This warranty is conditioned upon the prepaid return of the equipment claimed to be defective to an authorized CANABLAST distributor for verification of the claimed defect. If the claimed defect is verified, CANABLAST will repair or replace free of charge any defective parts. The equipment will be returned to the original purchaser, transportation prepaid. If the inspection of the equipment does not disclose any defect in material or workmanship, repairs will be made at a reasonable charge, which charges may include the costs of parts, labor, and transportation.**

**THIS WARRANTY IS EXCLUSIVE, AND IS IN LIEU OF ANY OTHER WARRANTIES, EXPRESSED OR IMPLIED, INCLUDING BUT NOT LIMITED TO WARRANTY OF MERCHANTABILITY OR WARRANTY OF FITNESS FOR A PARTICULAR PURPOSE.**

**CANABLAST's sole obligation and the buyer's sole remedy for any breach of warranty shall be as set forth above. The buyer agrees that no other remedy (including, but not limited to, incidental or consequential damages for lost profits, lost sales, injury to person or property, or any other incidental or consequential loss) shall be available. Any action for breach of warranty must be brought forward within one (1) year of the date of sale.**

**CANABLAST MAKES NO WARRANTY, AND DISCLAIMS ALL IMPLIED WARRANTIES OF MERCHANTABILITY AND FITNESS FOR A PARTICULAR PURPOSE, IN CONNECTION WITH ACCESSORIES, EQUIPMENT, MATERIALS OR COMPONENTS SOLD BUT NOT MANUFACTURED BY CANABLAST. These items sold, but not manufactured by CANABLAST (such as electric motors, switches, hose, etc.), are subject to the warranty, if any, of their manufacturer. CANABLAST will provide the purchaser with reasonable assistance in making any claim for breach of these warranties.**

### **LIMITATION OF LIABILITY**

**In no event will CANABLAST be liable for indirect, incidental, special or consequential damages resulting from CANABLAST supplying equipment hereunder, or the furnishing, performance, or use of any products or other goods sold hereto, whether due to a breach of contract, breach of warranty, the negligence of CANABLAST, or otherwise.**

**Report all accidents or "near misses" which involve CANABLAST products to:**  
- Technical Assistance

**The following items are not covered under the CANABLAST warranty policy:**  
- Parts or chassis replacement due to normal wears.

**Defective material or workmanship is not considered normal wear**

## SPÉCIFICATIONS DU CABINET

TYPE DE CABINET	ECONO 26	ECONO 28	ECONO 36
Item Nb	628104	628157	628207
Dim. ext. (P x L x H)	26" x 36" x 67"	28" x 44" x 67"	36" x 36" x 67"
Dim. int. (P x L x H)	26"x36"x30"	28" x 44" x 30"	36" x 36" x 31"
Door Dim. (L x H)	20"x29"	22" x 29"	30" x 29"
Door	Simple		
Weight	375	415	455
Cabinet construction	14 gauge		
Floor Capacity	300 lbs		
Gloves	Rubber 8" diam.		
Blasting system	Suction trigger		
Piping	3/8 " diam.		
Nozzle material	Ceramic		
Abrasive Regulator	AR 3/4		
Blast Gun	G15-CN1-5		
Pressure regulator/	Optional		
Glass	14" x 22"		
Lighting (W)	250, halogen		
Dust collector	DB 13	DC 50	
Filter area (square feet)	13	50	
Dimensions (L x H)	15"x 66"	20" x 20" x 78"	
Motor (hp)	1/3		
Fan (cfm)	400		
Fan silencer (dB A)	Under 80		
Electrical system (V)	120		

## **NOTICE TO BUYERS AND USERS OF OUR PRODUCTS AND THIS INFORMATION DOCUMENT**

The products described in this document and the information on these products is aimed at professionals and advanced users of abrasive blasting equipment.

No representation is made or intended as to the suitability of the products described for a particular purpose of the request. No statement is intended or made as to the efficiency, production rate, or the useful life of the products described below. Estimate rates of production or production in regard to the finishes are the responsibility of the user and must be derived solely from the user's experience and expertise, and should not be based on information in this document.

The products described herein may be combined by the user in a variety of means for uniquely determined by the user. No statement is intended or made as to the balance of engineering skill or combination of products by the user's choice, or concerning compliance with the regulations or the practice of these combinations components or products. It is the responsibility of users to learn about the products mentioned in this document to become familiar with the laws, regulations and safety practices that apply to these products, equipment connected to these products and materials that can be used with these products.

It is the responsibility of the user to ensure that appropriate training of operators was carried out and a safe working environment is provided.

Our company is proud to offer a variety of products for industrial blasting, and we trust that our professionals use their industry knowledge and expertise for safe and effective use of these products.

## **SAFETY AND WARNING**

### **GENERAL SAFETY**

1. Carefully inspect the shipping carton for any signs of transport damage. The damage to the carton often indicates possibility of transport damage to the equipment inside.
2. Carefully remove your CANABLAST SANDBLASTING CABINET from the shipping carton and skid.
3. Check your equipment immediately to ensure that it is free of transport damage. Report any transport damage without delay for possible claim procedures. International Surface Technologies inc. is not responsible for damage to equipment after it leaves our warehouse.
4. 4. Check the equipment list and compare it with the parts you have received. If any parts are missing, contact the supplier you purchased the equipment from.

**Before operating the CANABLAST SANDBLASTING CABINET, read this Instruction Manual completely. All CANABLAST products are engineered and manufactured to the highest performance standards and have been subjected to detail testing before shipment from the factory.**

## DANGER AND WARNING LABELS



1

2

3

4

5

1. Wear a respirator
2. Observe the warning at any time.
3. Read the instruction manual.
4. Wear rubber gloves.
5. Wear eye protection before using it.

### **WARNING**

**« READ ALL INSTRUCTIONS » FAILURE TO FOLLOW THE SAFETY RULES IDENTIFIED BY A BULLET (°) SYMBOL LISTED BELOW AND OTHER SAFETY PRECAUTIONS MAY RESULT IN SERIOUS PERSONAL INJURY.**

**« SAVE THESE INSTRUCTIONS »**

## GENERAL SAFETY RULES

- **KEEP WORKING AREA CLEAN.**
- **KEEP CHILDREN AWAY.** Do not let visitors come in contact with the equipment. All visitors should be kept away from the work area.

## PERSONAL SAFETY

- **GUARD AGAINST ELECTRIC SHOCK.** Non-skid footwear is recommended where damp or wet ground may be encountered. A ground fault circuit interrupter protected power line must be used for these conditions.
- **DRESS PROPERLY.** Do not wear loose clothing or jewelry. They can be caught in the moving parts. Wear protective hair covering to contain long hair
- **USE SAFETY EQUIPMENT. WEAR SAFETY GOGGLES** or glasses with side shields.
- **WEAR A DUST PROOF MASK. .**
- **STAY ALERT. USE YOUR COMMON SENSE.** Concentrate on what you are doing. Do not operate the unit when you are tired or under the influence of drugs
- **DO NOT OVERREACH.** Keep proper footing and balance at all times.
- **BEFORE CONNECTING THE UNIT,** be sure the power is the same as that specified on the nameplate of the Sand Blasting Cabinet. With power greater than that specified on the Nameplate can seriously injure the user – as well as damage the Unit.

## UNIT USE AND CARE

- **DO NOT FORCE THE UNIT.** It will perform better and safer at the rate for which it was designed.
- **THE USE OF ANY OTHER ACCESSORIES** not specified in this manual may create a hazard.
- **CLOSE THE MAIN BREAKER SWITCH BEFORE SERVICING** or when not in use.
- **DO NOT ALTER OR MISUSE THE UNIT.** These units are precision built. Any alteration or modification not specified is misuse and may result in a dangerous situation.

Only trained repairmen should attempt (●) **ALL REPAIRS**, electrical or mechanical. Contact the nearest IST Canablast repair service facility. Use only IST Canablast replacement parts; any other parts may create a hazard.

## SAFETY RULES

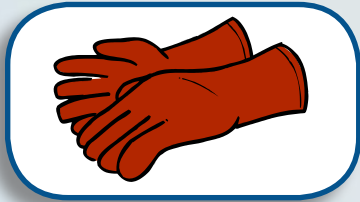

- **THE OPERATOR MUST WEAR** protective water-proof rubber gloves to prevent contact between his hands and the products used for sandblasting.
- **IF EYES COME IN CONTACT WITH ABRASIVE** rinse thoroughly with water.
- **BEFORE USING** the Sandblasting Cabinet, make sure that all safety devices are in perfect operating condition.
- **BECOME FAMILIAR WITH THE CONTROLS** and their functions before commencing work.
- **BE CAREFUL** when you load or unload the abrasive in the unit. Make sure you do not splash or spill the contents on the workshop floor.
- **THE OPERATOR MUST PERIODICALLY** check the level of the abrasive contained in the equipment to be sure to not run this pump dry.
- **DO NOT ALLOW FAMILIARITY GAINED FROM FREQUENT USE OF YOUR WASHER TO BECOME COMPLACENCE.** Always remember that a careless fraction of a second is sufficient to inflict severe injury.
- **DO NOT ALTER OR MISUSE THE UNIT.** Any alteration or modifications is a misuse and may result in serious personal injuries.



- **THE INSTALLATION SITE MUST PERMIT PERSONNEL TO EASILY AND QUICKLY MOVE AWAY DANGER ZONES IN CASE OF AN EMERGENCY.**
- **DO NOT USE THE UNIT TO** blast or degrease objects designed to come in contact with food
- **COMPLY WITH LAWS IN THE COUNTRY** where the washer is installed regarding the use and disposal of the products used to wash clean objects.

**THINK SAFETY! SAFETY IS A COMBINATION OF THE OPERATOR'S COMMON SENSE, KNOWLEDGE OF THE SAFETY AND OPERATING INSTRUCTIONS AND ALERTNESS AT ALL TIMES WHEN THE UNIT IS BEING USED.**

## INTRODUCTION

Welcome to the CANABLAST<sup>®</sup> family of sandblasting products. This booklet contains helpful information and acquaints you with the operation and maintenance of your equipment. Please read carefully and follow our recommendations to assure trouble free operation. If you have any questions, please do not hesitate to contact your distributor or our technical service.

## INSTALLATION

1. Make sure the cabinet is leveled and well grounded. Do not place on a wooden floor or a rubber mat, unless a ground wire has been installed. Check with a qualified electrician.
2. All CANABLAST ECAB series cabinets are equipped with a tubular type dust bag model DB-13 for dust collection or an optional high-performance dust collector model DC-50 or DC-100. .

### a) DB -13 Dust bag :

The dust bag, pail and clamps are packed inside the cabinet. Place dust bag behind the cabinet and install the opening of the dust bag to the outlet of the reclaimer using the supplied clamp. (Page 14, No. 21).

### b) DC-50 or DC-100 Dust collector :

The dust collector should be located on a leveled area near the back of the cabinet, at the right side. Attach one end of the corrugated discharge hose to the outlet of the reclaimer and the other end to the inlet located at the bottom of the dust collector. Secure both ends with the supplied clamps. *See dust collector section for more details.*

3. The air pressure regulator is located on the inside of the right support leg of the cabinet (Page 11, No. 14) and the air inlet is located on the right side of the cabinet (Page 13, No. 21).

Connect your shop's air supply line to the air inlet. The hose should have a minimum of 1/2 inch inside diameter. Never use male-female quick couplings. **Choose couplings that offer as little restriction to the airflow as possible.** Compressed air must be clean, dry, and oil free.

All electrical connections to the CANABLAST cabinet should be made by a qualified electrician and must adhere to the codes, standards, and procedures specified by the authority having jurisdiction. The customer is responsible for providing appropriate disconnecting means adjacent to the equipment for each incoming power circuit.



It is important to connect the Canablast system to the ground to discharge static electricity, which can be generated when sanding. The ground can also reduce the discomfort to which an operator may face when static electricity is dissipated.

## ABRASIVE MEDIA LOADING

Start the electric motor. Open the cabinet door and slowly pour about 25 lbs of abrasive inside the cabinet. Abrasive will be transferred automatically to the reclaimer.

**Important note :** Your suction cabinet is designed to operate efficiently with most of light and reclaimable abrasive media on the market. However, certain types such as sand, crunched glass or silica are not recommended and should not be used in your blast cabinet. These abrasives generate very fine dust that may block the bag's pores, obstruct the ventilation system and cause dust accumulation inside the cabinet while in use. Instead, use reclaimable abrasives such as glass beads or aluminum oxide.

**Warning :** Sudden dumping of media into the cabinet will clog the return hose and stop the reclaiming system. To operate properly, your CANABLAST system requires clean, dry air. Moisture or oil in the compressed air supply can contaminate the abrasive, which can prevent it from flowing freely and cause inefficient blasting

## OPERATION

Turn on compressed air and turn on lightning and motor with the power switch. *Compressed air must be clean, dry, and oil free*

1. Depressing blast control pedal will release compressed air flow to the blast gun. As the compressed air passes through the air jet, it creates a vacuum inside the gun and sucks up the media from the reclaimer and discharges it out through the nozzle.
2. After the media has blasted the part, the reclaiming system vacuums up the abrasive, dust and foreign material through the conduit at the bottom of the cabinet to the reclaimer (Page 14, no. 5). The reusable abrasive is separated from the dust and foreign material and is returned to the storage hopper for reuse, the dust and fine particles are filtered by the dust bag or the dust collector. Larger pieces of contaminants are trapped in the hopper's screen drawer.

## RECLAIMER

Although the reclaimer is factory set, it is possible to increase the amount of fine dust to be sucked up by the dust bag or dust collector. Just move the rubber band to adjust the obstruction of the holes located behind it. (Page 15, No. 6).

## MAINTENANCE

To avoid blockage, it is highly recommended to empty and clean the reclaimer's screen drawer every day. (Page 14, no. 8)

## SHUT DOWN

1. Once cleaning is finished, await 10 to 15 seconds before turning off the engine and opening the door of the cabinet in order to allow the evacuation of dust in suspension.
2. Close air supply
3. Turn power switch to the off position.

## USING YOUR SUCTION CABINET

1. **Check both the quantity and quality of abrasive frequently. If required, clean out the system and reload with new media. During normal blasting operation, the media should be replaced completely after 8 hours. Make sure to use dry, clean abrasive such as glass beads no. BT-6 (50-70).**
2. With power switch at *off*, shake your DB 13 dust bag vigorously by hand in order to bring the dust down into the dust pail. If cabinet is used continuously, repeat operation every 8 hours. For DC 50 and DC 100, **See dust collector section for more details.**
3. Empty dust pail or dust collector's bottom hopper regularly

**Warning:** Never shake bags while cabinet reclaimer is running. Never wash dust bags instead use compressed air, **blowing from the outside to the inside of the bag**, (the opposite would clog the bag's pores and make it unusable).

4. Located at the bottom of the reclaimer, the AR 3/4 abrasive regulator (Page 14, no. 11). Be sure that nothing seals off the hole completely. You can adjust the opening using the adjustable clamp that must be located over it, covering about 2/3 of the hole (Page 16). **A smaller opening will bring more abrasive to the nozzle; a wider opening will bring less abrasive.** A complete opening or a complete covering will interrupt the abrasive flow.
5. Make sure you have a proper air jet/nozzle combination. Standard CANABLAST E CAB® (3, 5 or series suction cabinets are equipped with 5/32 « air jets and 5/16» nozzles. A simple way to determine if you have an incorrect combination is to check the abrasive regulator at the bottom of the reclaimer when the operator's pedal is depressed. If media is being discharged out of the regulator, there is an incorrect jet/nozzle combination or an obstruction inside the gun.

### PROPER JET COMBINATION

JET	NOZZLE	AIR CONSUMPTION
1/8"	1/4"	21 CFM * @ 80 PSI *
5/32"	5/16" standard	34 CFM* @ 80 PSI *
3/16"	3/8"	48 CFM * @ 80 PSI *
7/32"	7/16"	65 CFM * @ 80 PSI *

\* CFM : Cubic Feet / Minute

\* PSI : Pounds / Square Inch

6. Check for wear on all parts in direct contact with the blasting action: nozzle, gloves, window, plastic shield, air-jet, gun etc. Special attention must be given to nozzle, nozzle ring and rubber protector (Page 16) to avoid premature wear of gun. Make sure ventilation inlet is always free of obstruction

**Warning :**

Make sure to use appropriate safety equipment. (Ear plugs, dust mask etc.).

## SCHEMATIC OF UNITY

View right side

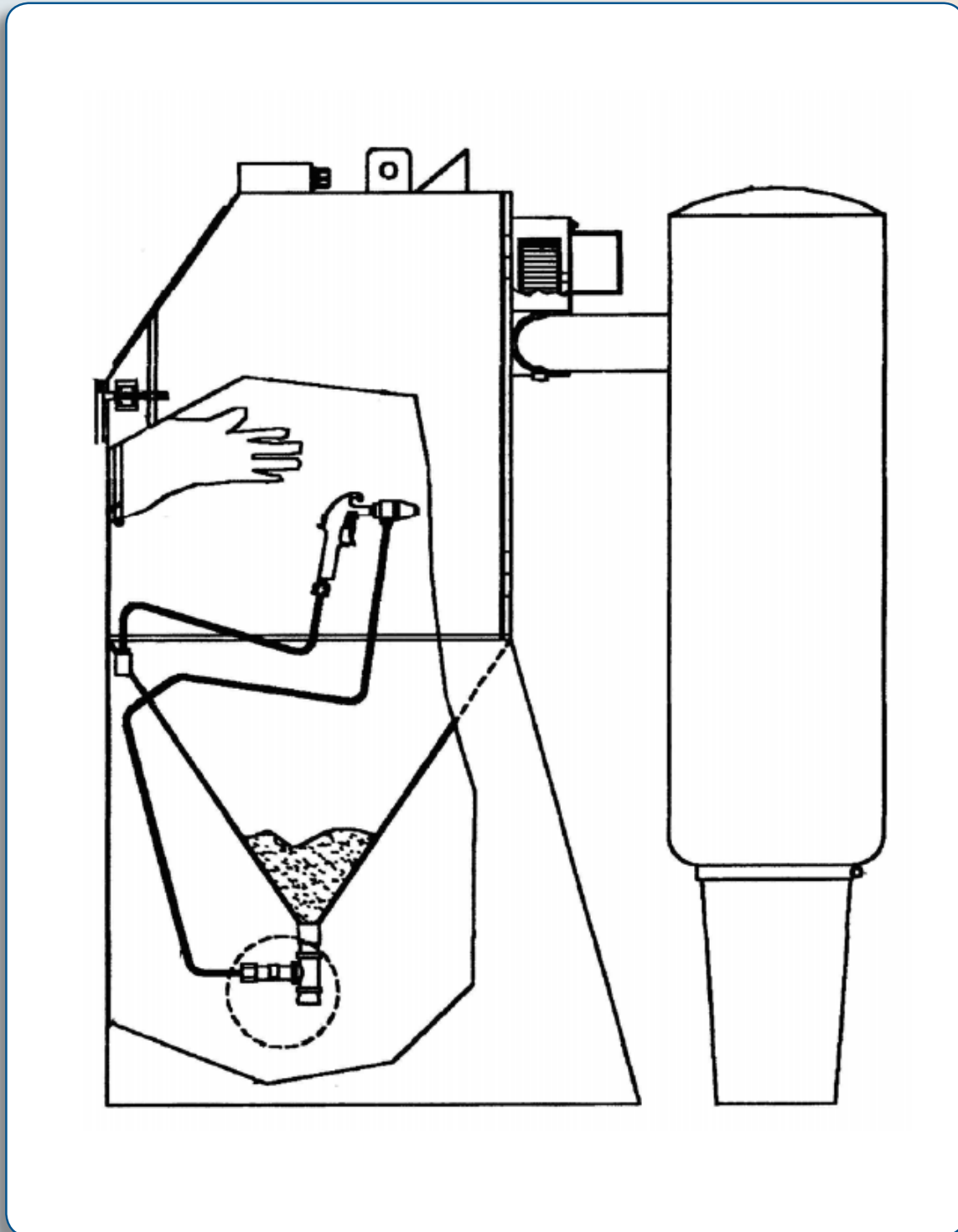

## SCHEMATIC OF UNITY Face view

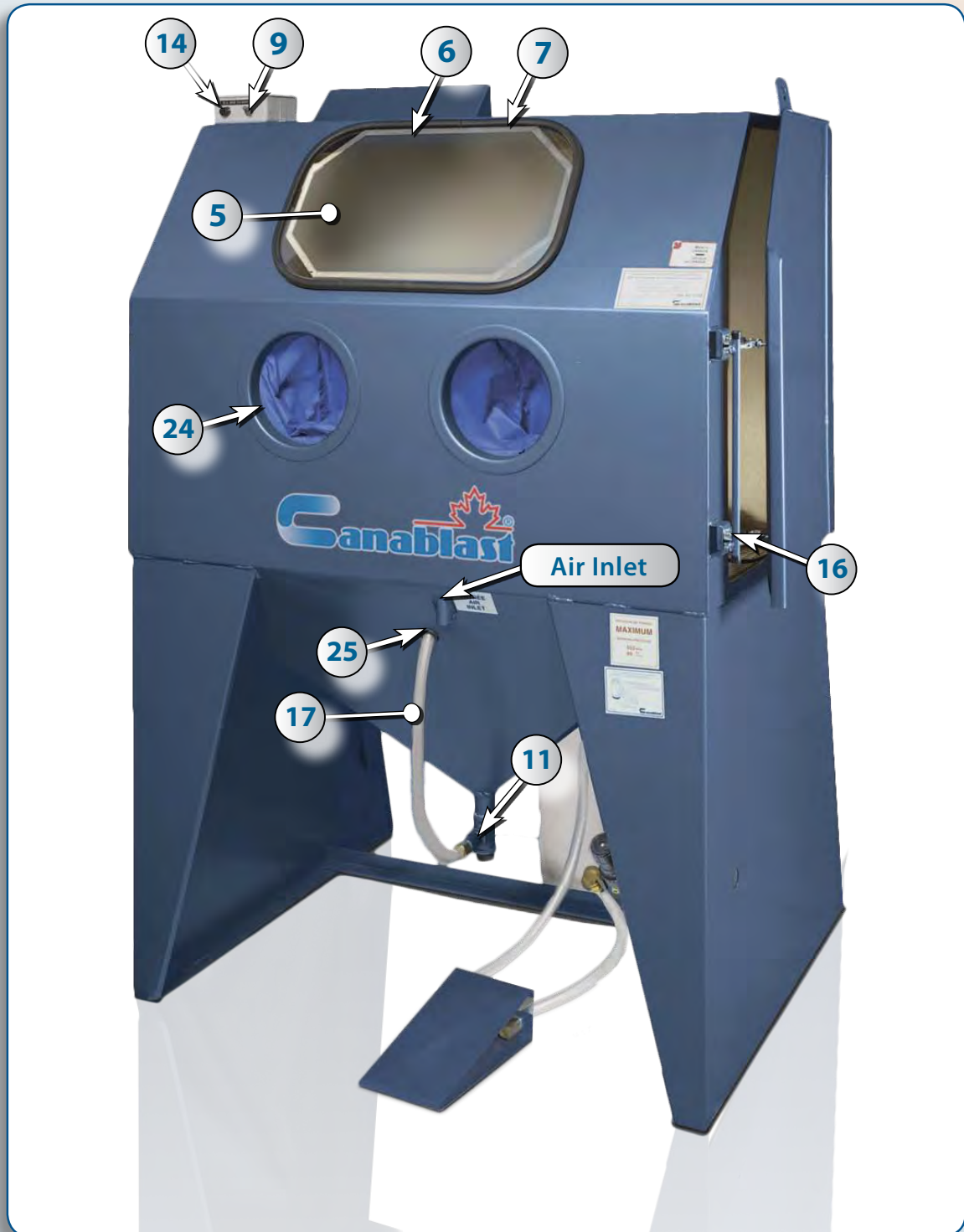

## SCHEMATIC OF UNITY Inside view

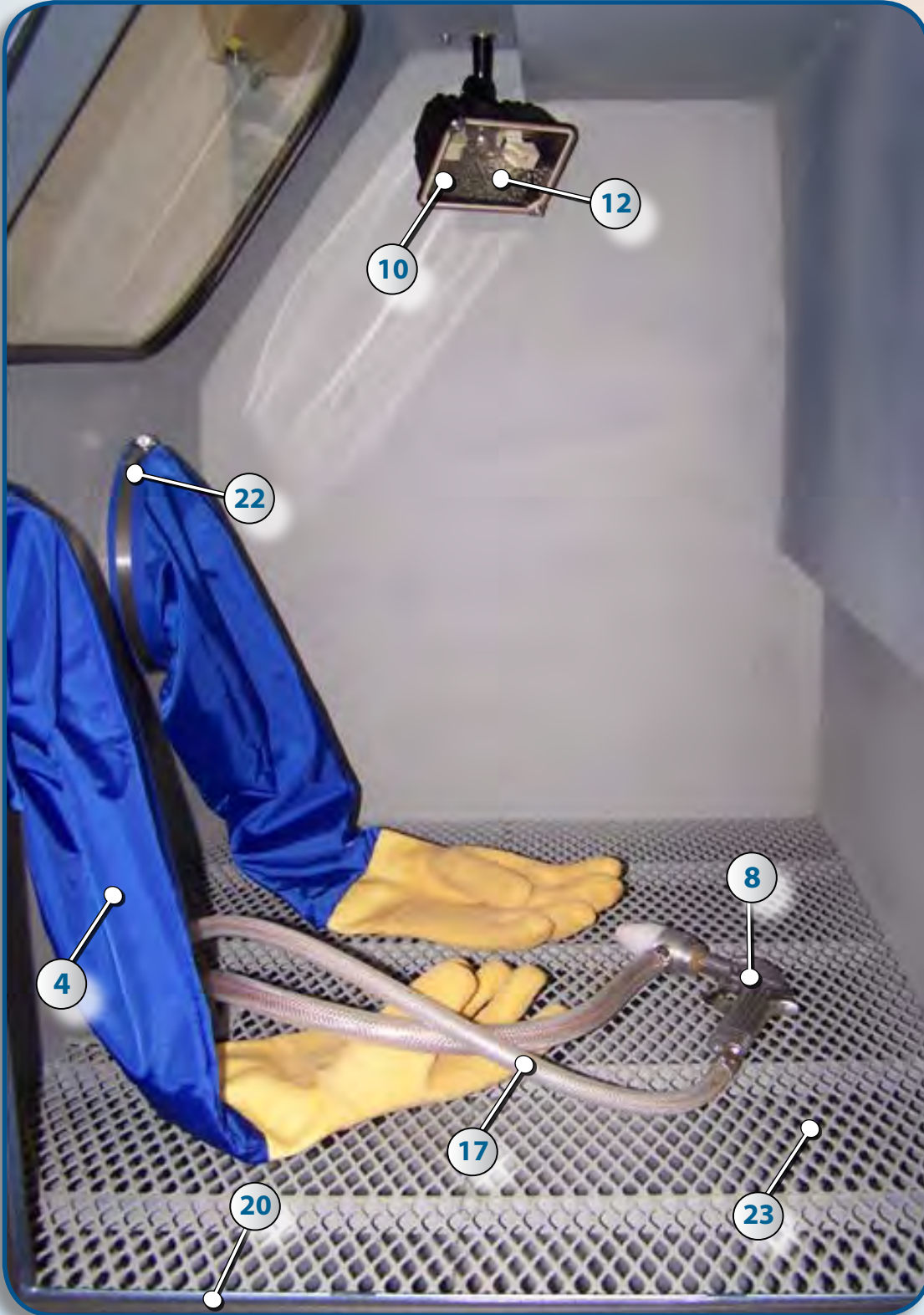

## SCHEMATIC OF UNITY Rear view



## SCHEMATIC OF UNITY Parts List

#	STOCK	DESCRIPTION
1	616306	1/ 3 hp electric motor 120 V, AC, 60 Hz, 3450 rpm
2	601315	DB-13 dust bag
3	601310	Dust pail
4	603212	E3 nylon sleeve gloves, 8 " ID X 30 " long (sold in pairs only)
5	610205	22 " x 14 " laminated window
6	613026	E3 window's rubber gasket
7	610207	G15-CN1-5, complete gun with 5/16" nozzle (standard )
8	610101	ON / OFF POWER SWITCH
9	617014	AR 3 /4 abrasive regulator
10	617126	Pyroceramic glass
10-1	617127	1/3 hp ECONOBLAST® turbine, 1/ 2 " shaft
11	608010	AGC 10 amperes 250 V fuse
12	610213	250 W halogen light bulb for 617126 flood light
13	610523	Standard CANABLAST® complet door lock
14	616935	1/2 " Ø PVC abrasive conveying hose (sold per foot)
15	617127	T188 (11 1/4 ") clamp for pail
16	610288	3/ 8" Ø air hose (sold per foot)
16a	910223	Low density, self adhesive rubber foam 1" x 1/4 " (sold per foot)
17	606104	T64 (4 ") Ø clamp
18	624137	T128 (8 ") Ø clamp for gloves
19	606103	ECONO 26x36 work surface screen
20	618321	ECONO 28x44 work surface screen
21	624117	8" Ø glove flange (unit)
22	624128	Bague de serrage T128 8" Ø
23-1	610452	Planché grillagé ECONO 2636
23-2	610453	Planché grillagé ECONO 2844
23-3	610451	Planché grillagé ECONO 3636
23-4	610454	Planché grillagé ECONO 3648
24	610229	Bride de gant (flange) 8" Ø (vendu à l'unité)
25	618126	Grommet

## AR-3/4 ABRASIVE REGULATOR (608010) ADJUSTMENT

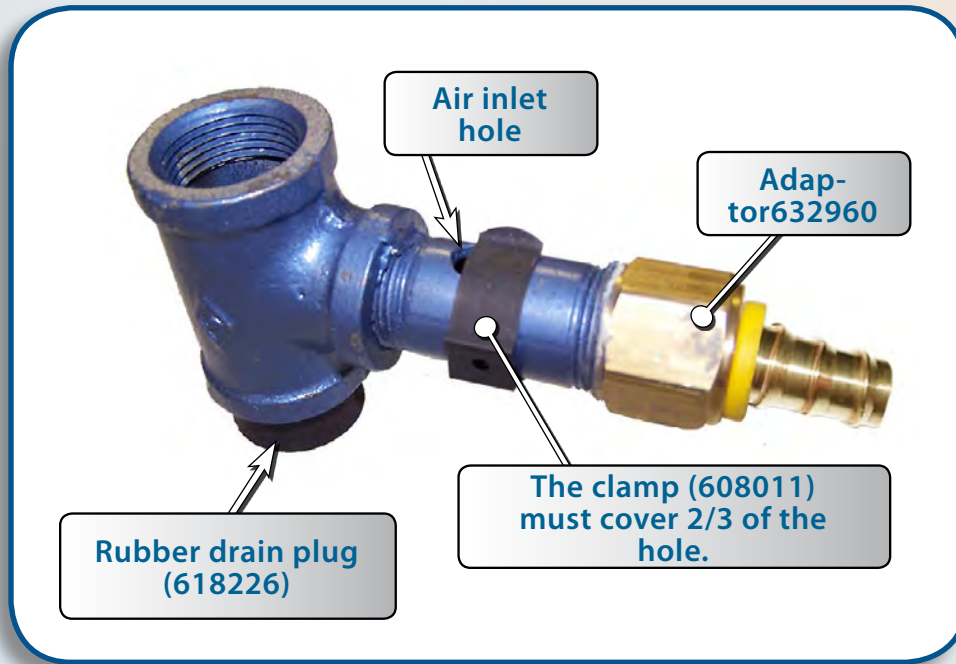

## SCHEMATIC OF BLAST GUN G15 FOR SUCTION CABINET (610101)

Compleat repair kit # 910104

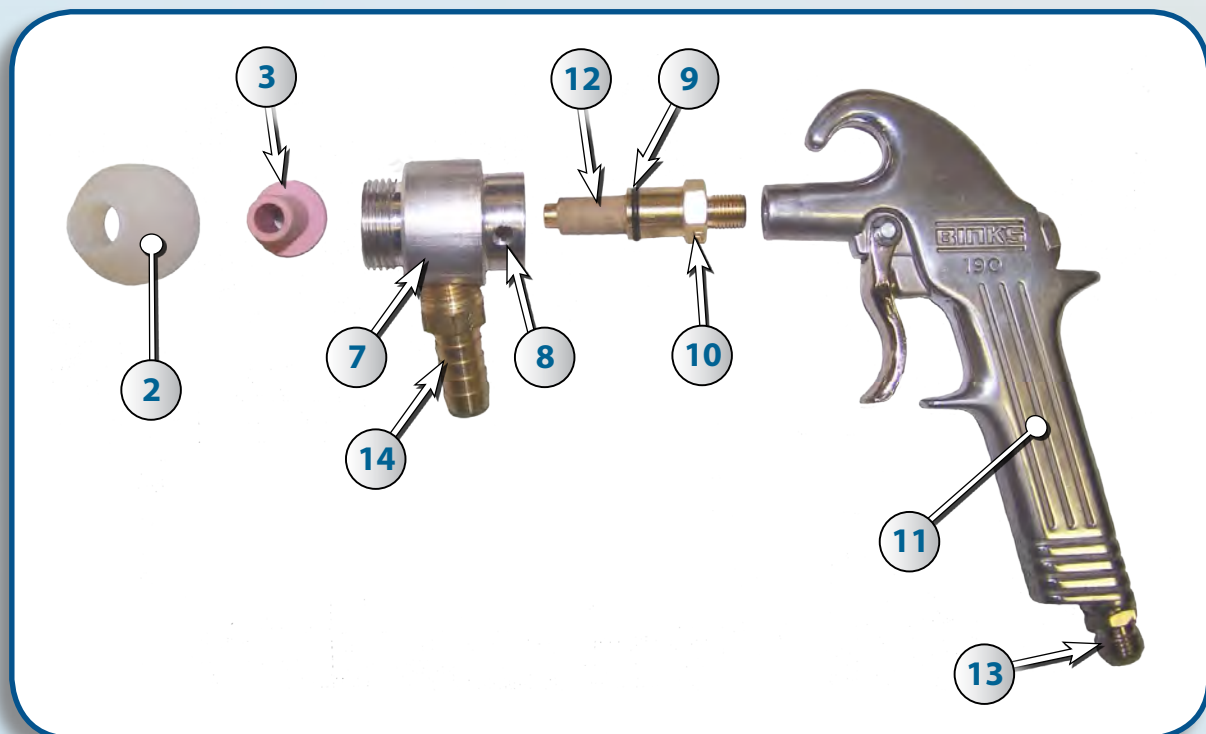

## SPARE PARTS FOR BLAST GUN G15

### Parts list

#	STOCK	DESCRIPTION
1	610101	G15-CN1-5, complet blast gun w/ ceramic nozzle 5/16" (standard)
	610100	G15-CN1-4, complet blast gun w/ ceramic nozzle 1/4"
	610103	G15-TN1-5, complet blast gun w/ tungsten carbide nozzle 5/16"
	610102	G15-TN1-4, complet blast gun w/ tungsten carbide nozzle 1/4"
2	607039	NA-G5 nozzle adaptor
3	605001	CN1-5, 5 /16 " Ceramic nozzle (standard)
	605000	CN1-4, 1/4" Ceramic nozzle
	605003	TN1-5, 5/16" Tungsten carbide nozzle
	605002	TN1-4, 1/4" Tungsten carbide nozzle
4	610106	G15-BC1-3, complet blast gun w/boron carbide nozzle 3/16"
	610107	G15-BC1-4, complet blast gun w/boron carbide nozzle 1/4"
	610108	G15-BC1-5, complet blast gun w/boron carbide nozzle 5/16"
	610105	G15-DC1-3, complet blast gun w/tungsten carbide nozzle 3/16"
5	605415	BC1-3 3/16", Boron carbide nozzle
	605416	BC1-4 1/4", Boron carbide nozzle
	605417	BC1-5 5/16", Boron carbide nozzle
	605359	DC1-3 3/16", Tungsten carbide nozzle
6	607043	3/4" tread, male nozzle adaptor
7	610111	G-15 Suction head
8	NPN	NPN Hexagonal screw 1/4"-20 X 1/4"
9	618100	G 15 "O" ring
10	610114	G 15 3/32" air jet for 5 /16" nozzle (standard)
	610113	G 15 1/8" air jet for 1/ 4" nozzle
	610112	G 15 3/32" air jet for 3 /16" nozzle
11	610110	G 15 Gun body
12	618218	G 15 rubber protector
13	606103	3/8" air hose (sold per foot)
14	632761	3/8" MPT x 1/2" stem brass mender
15	606104	PCV 1/2" abrasive conveying hose (sold per foot)

## SPARE PARTS FOR BLAST GUN

### Parts list (pre-assembled)

G5 COMPLETE BLAST GUN (PRE-ASSEMBLED )		NOZZLE			AIR JET (COMPLETE)	ORIFICE ⊥
		TYPE	ORIFICE	CODE		
610121	Ceramic	CN2-4	1/4"	605004	610116	1/8"
610120	Ceramic (standard)	CN2-5	5/16"	605005	610117	5/32"
610166	Ceramic	CN2-6	3/8"	605015	610109	3/16"
610122	Ceramic	CN2-7	7/16"	605006	610118	7/32"
610123	Tungsten	TN2-4	1/4"	605007	610116	1/8"
610124	Tungsten	TN2-5	5/16"	605008	610117	5/32"
610167	Tungsten	TN2-6	3/8"	605018	610109	3/16"
610125	Tungsten	TN2-7	7/16"	605009	610118	7/32"
610126	Boron carbide	BN2-4	1/4"	605010	610116	1/8"
610127	Boron carbide	BN2-5	5/16"	605011	610117	5/32"
610168	Boron carbide	BN2-6	3/8"	605021	610109	3/16"
610128	Boron carbide	BN2-7	7/16"	605012	610118	7/32"



## **WARRANTY INFORMATION / TECHNICAL ASSISTANCE**



**For more information, prices or technical assistance,  
contact your local Canablast distributor or call / fax our  
Consumer Information Numbers :**

**Tel. : 1 800 361-1185    Tel. : 450 963-4400    Fax : 450 963-5122**

**Or visit us at :**

**[www.canablast.com](http://www.canablast.com)**

